

CITY OF NAPOLEON GENERAL PERMIT APPLICATION

THIS APPLICATION IS FOR RESIDENTAL CONSTRUCTION INCLUDING BUILDING, ELECTRICAL, PLUMBING, MECHANICAL & REMODELING

BP2010-42

DATE 6-24-10 JOB LOCATION 716 W. Clinton St
 OWNER Mike Macay TELEPHONE # 572-6237
 OWNER ADDRESS 716 W. Clinton St
 CONTRACTOR John Light CELL PHONE # 419 261 4781
 DESCRIPTION OF WORK TO BE PERFORMED Rebuild Front Porch Floor
 ESTIMATED COMPLETION DATE 7-15-10 ESTIMATED COST 4000

Affected Floor Area (AFA): In existing structures, it is the area affected by the improvement, i.e. a new wall dividing a room (the AFA would be only the room and not all the rooms).

DESCRIPTION	FEE	TOTAL COST
<i>Addition & Alterations</i> Square foot in (AFA) x \$0.05 = \$	+	\$25.00 = \$
<i>Electrical</i> Circuits in (AFA) x \$3.00/Circuit = \$	+	\$25.00 = \$
<i>Plumbing</i> Traps in (AFA) x \$3.00/Trap = \$	+	\$25.00 = \$
<i>Siding and/or Roofing</i>		\$25.00 \$
<i>Windows/Doors</i>		\$25.00 \$
<input checked="" type="checkbox"/> <i>Decks</i>		\$25.00 \$ <u>25.00</u>
<i>Garage and Shed over 200 SF (Detached)</i>		\$25.00 \$
<i>Electrical Service Upgrade</i>		\$25.00 \$
<i>Water Heater</i>		\$25.00 \$
<i>Furnace and/or AC Replacement</i>		\$25.00 \$
	MBP (100.3100.46510)	Subtotal: \$ <u>25.00</u>
	(100.0000.42700) PLUS Ohio Board of Building Standards Fee + 1%	\$ <u>.25</u>

TOTAL FEE: \$ 25.25

I FULLY UNDERSTAND THAT NO EXCAVATION, CONSTRUCTION OR STRUCTURAL ALTERATION, ELECTRICAL OR MECHANICAL INSTALLATION OR ALTERATION OF ANY BUILDING STRUCTURE, SIGN, OR PART THEREOF AND NO USE OF THE ABOVE SHALL BE UNDERTAKEN OR PERFORMED UNTIL THE PERMIT APPLIED FOR HEREIN HAS BEEN APPROVED AND ISSUED BY THE CITY OF NAPOLEON BUILDING/ZONING DEPARTMENT.

I hereby certify that I am the Owner of the named property, or that the proposed work is authorized by the Owner of record and that I have been authorized by the Owner to make this application as his/her authorized agent and I agree to conform to all applicable laws of the jurisdiction. In addition, if a permit for Work described in this application is issued, I certify that the code official or the code official's authorized representative shall have the authority to enter areas covered by such permit at any reasonable hour to enforce the provisions of the code(s) applicable to such permit.

I HEREBY ACKNOWLEDGE THAT I HAVE READ AND FULLY UNDERSTAND THE ABOVE LISTED INSTRUCTIONS.

SIGNATURE OF APPLICANT: [Signature] DATE: 6-24-10
 PRINT NAME: John Light

BATCH # 22705 CHECK # 3832 DATE 6-24-10

SCANNED

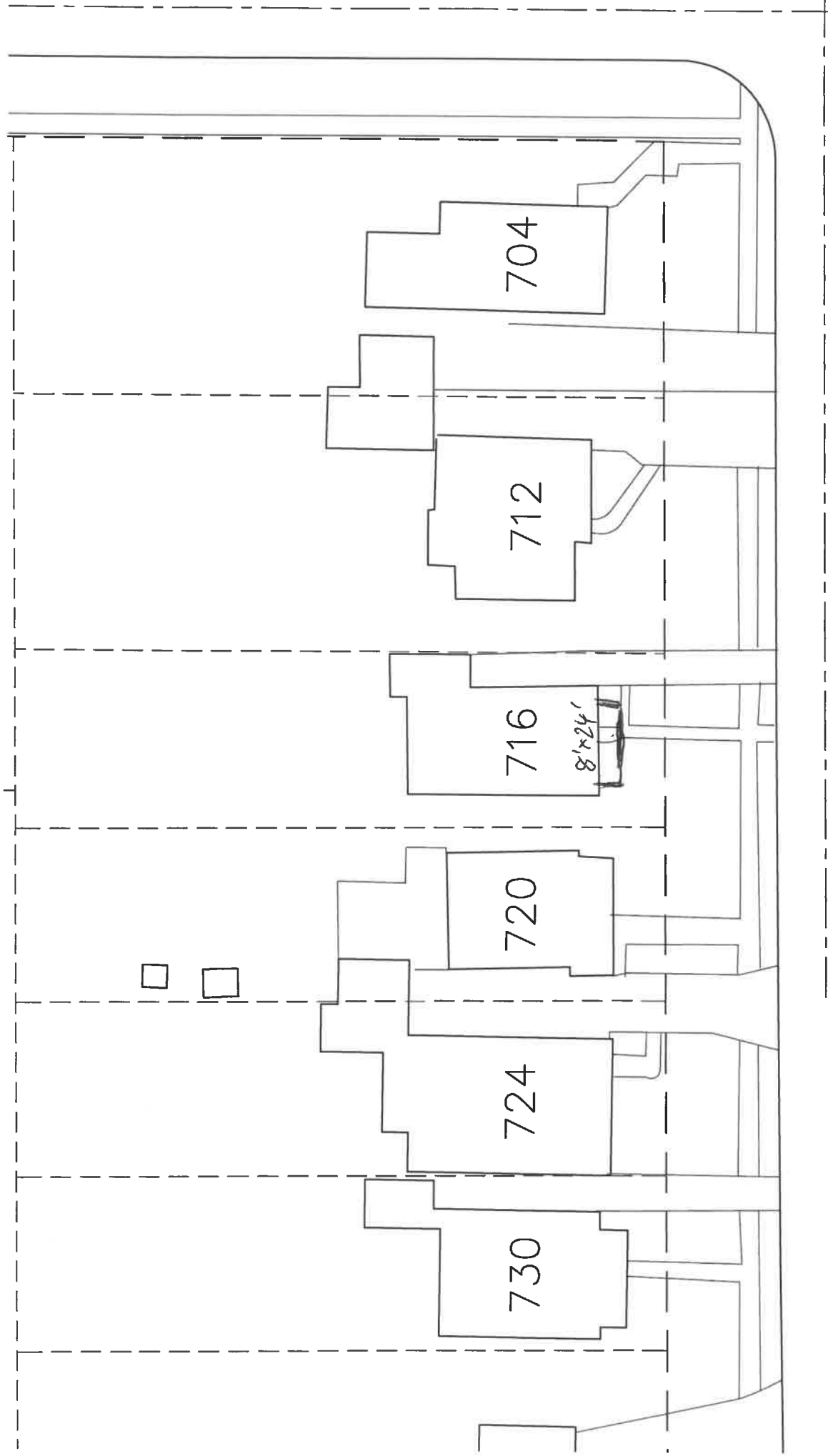

704

712

716

8'x24'

720

724

730

